



BOSCHERT

Das Original!



www.boschert.de
infokl@boschert.de



65 ans de partenariat avec nos clients

Services aux clients, fiabilité, exigence de haute qualité, flexibilité sont depuis cinquante ans les bases de notre entreprise. En tant que client vous êtes dès le début partie intégrante de l'équipe, et recevez tout notre soutien dans la réalisation de vos projets. Nous vous écoutons, agissons dans un esprit d'innovation et réagissons vite.

Une fois la certitude acquise d'avoir trouvé le bon partenaire, vous en viendrez vous aussi à nous confier la résolution de vos problèmes techniques et pratiques. Rapidement vous obtiendrez la meilleure solution grâce à l'expertise de nos ingénieurs qui s'appuient sur un concept technique testé.

Depuis un demi-siècle, notre volonté d'offrir à nos clients la meilleure solution est constante. Notre succès mondial, inégalé, nous conforte dans l'idée, que vous aussi serez bientôt un client satisfait.

Leader sur le marché, nous sommes là pour vous.

Over 65 Years of partnership with our customers

Customer service, reliability, quality and flexibility are the foundation of our company for more than 65 years. As a customer you become a part of our team from the beginning. You have our complete attention to fulfill your requirements. We listen to you. We act, innovate, and react quickly.

With the assurance that you have found the best source, you can trust to us the solution of the technical problems of your application. You can expect our technicians and engineers to provide you with the best and safest solution for your application. We have decades of service at your command.

It is our goal to offer all our customers, all over the world, the best solution possible. This is the secret to our success for over half a century. We welcome you as a customer and invite you to join our team. We are the standard of the industry. We are number one in all the world!

We are always available for you.

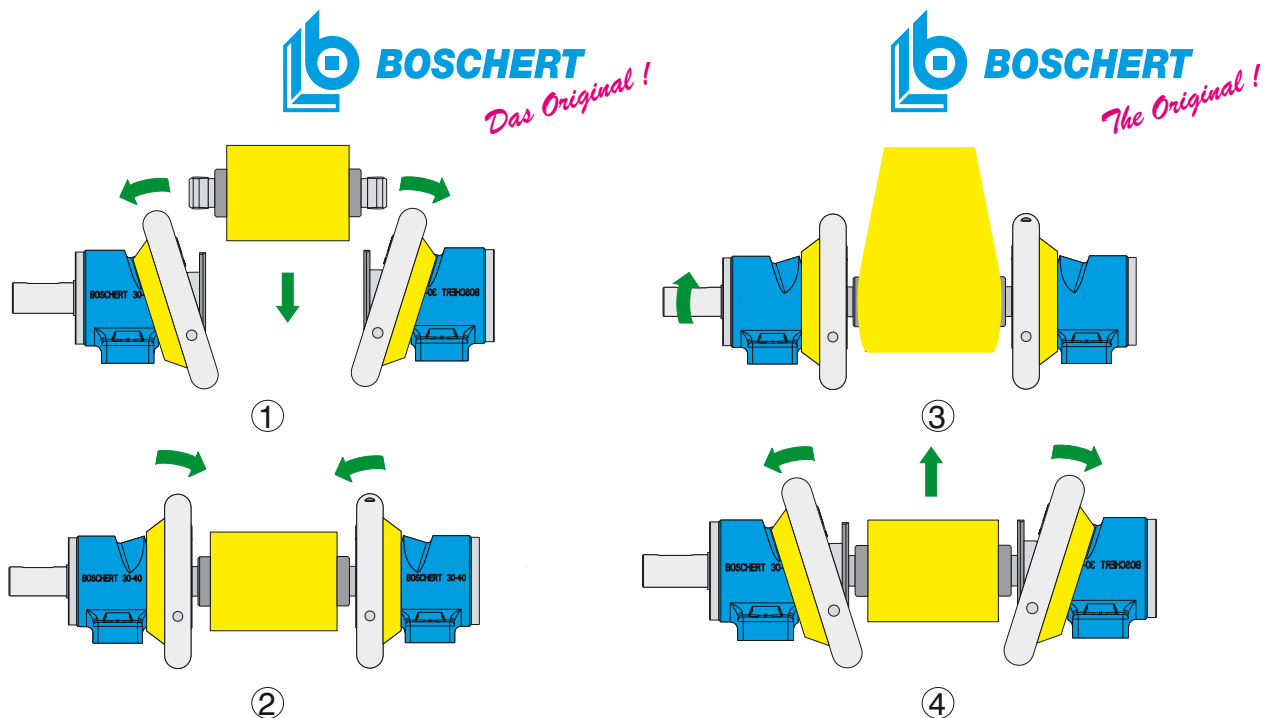

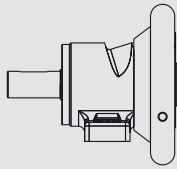

Palier Boschert

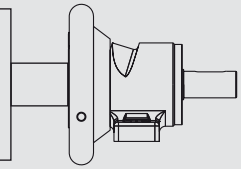

Type Model	Poids bobine max./ kg (max. beam weight / lbs)	Couple max. transmissible / Nm (max. torque / ft/lb)	Dimension du logement / mm (Square bar / inch)	Palier Boschert C Type C	Palier Boschert VT Type VT	plaques d'usure Wear plates
Mini	150 (330)	40 (29.5)	14-20 (0.5512 - 0.7874)	x		
19-25	400 (880)	120 (88.5)	19-25 (0.748 - 0.9843)	x		
22-30	800 (1760)	180 (132.8)	22-30 (0.8661 - 1.1811)	x	x	
30-40	1600 (3530)	350 (258.1)	30-40 (1.1811 - 1.5748)	x	x	
40-50	2800 (6170)	1100 (800)	40-50 (1.5748 - 1.9685)	x	x	
50-80	7000 (15430)	2350 (1700)	50-80 (1.9685 - 3.1496)		x	
80-120	12000 (24460)	10000 (7230)	80-120 (3.1496 - 4.7244)		x	
120-180	22000 (48500)	20000 (14468)	120-180 (4.7244 - 7.0866)			x
170-230	64000 (141090)	41000 (29660)	170-230 (6.6929 - 9.0551)			x

Nos différentes pièces d'entraînement Different insert shapes

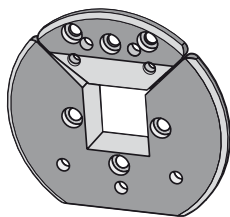

VT 1

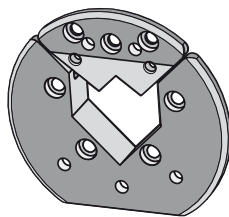

VT 2

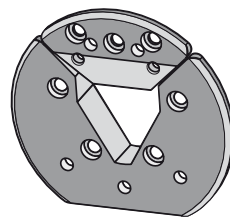

VT 6

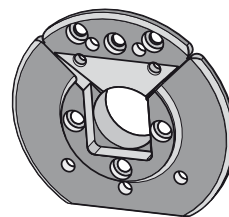

VT 7

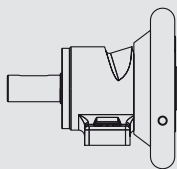

Safety chucks

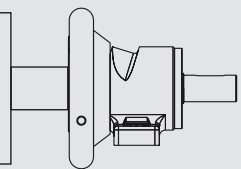



Palier à réglage

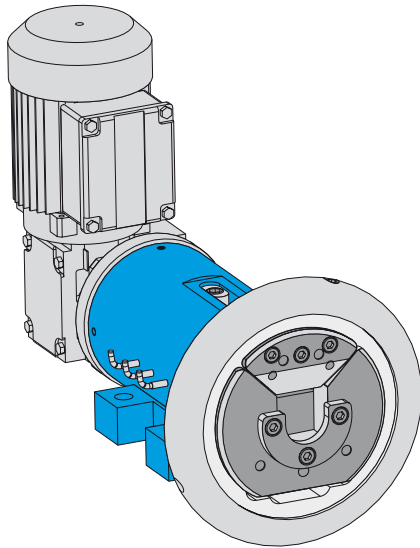
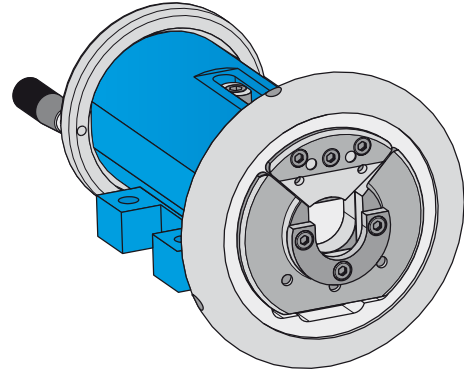
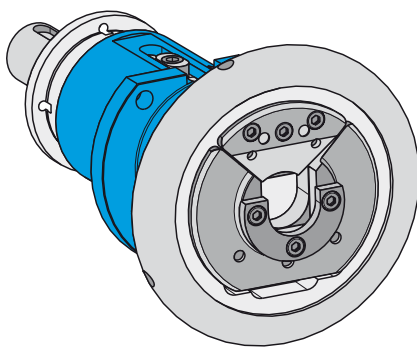

Type Model	Poids bobine max./ kg (max. beam weight / lbs)	Couple max. transmissible / Nm (max. torque / ft/lb)	Dimension du logement / mm (Square bar / inch)	Palier Boschert VT Type VT
22-30	800 (1760)	180 (132.8)	22-30 (0.8661 - 1.1811)	x
30-40	1600 (3530)	350 (258.1)	30-40 (1.1811 - 1.5748)	x
40-50	2800 (6170)	1100 (800)	40-50 (1.5748 - 1.9685)	x

Course: 50 mm / 100 mm
Adjustment:

Options: adaptation pour motorisation

Option: motorized adjustment

Nos différentes pièces d'entraînement
Different insert shapes

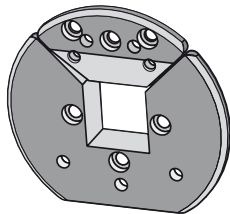

VT 1

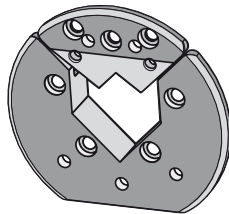

VT 2

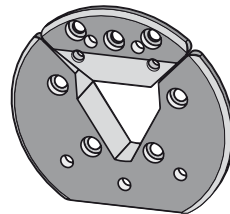

VT 6

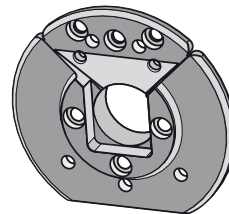

VT 7

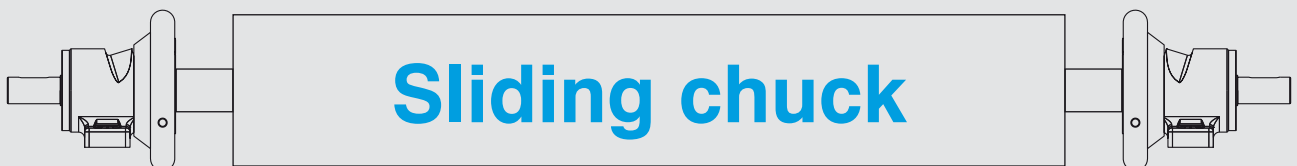

Sliding chuck

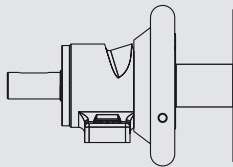

Paliers pneumatiques

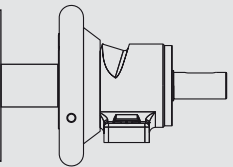

Palier Boschert A
A series

Type	Model	Poids bobine max. / kg (max. beam weight / lbs)	Couple max. transmissible / Nm (max. torque / ft/lb)	Dimension du logement / mm (Square bar / inch)	Palier Boschert VT Type VT
A40	1600	350	40	x	
	(3530)	(250)	(1.5748)		
A50	2800	1100	50	x	
	(6170)	(800)	(1.9658)		
A80	7000	2350	80	x	
	(15430)	(1700)	(3.1496)		

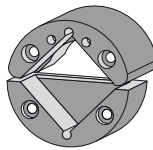

VT 2



Palier Boschert P
P series

Type	Model	Poids bobine max. / kg (max. beam weight / lbs)	Couple max. transmissible / Nm (max. torque / ft/lb)	Dimension du logement / mm (Square bar / inch)	Palier Boschert VT Type VT
P40	1600	350	40	x	
	(3530)	(250)	(1.5748)		
P50	2800	1100	50	x	
	(6170)	(800)	(1.9658)		

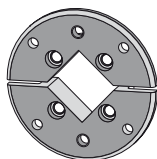

VT2

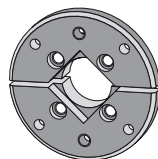

VT 7

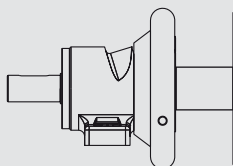

Pneumatic chuck

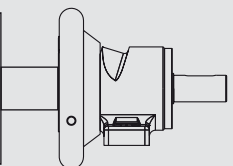



Freins

Freins	ESB	DSB	Multi
couple de freinage Nm	30 - 110 Nm	200 - 440 Nm	120 - 1200 Nm
pour Palier:	Mini / 19-25 / 22-30 / 30-40 / 40-50 / 50-80 / Palier à réglage / Palier A / Palier P		



Brakes	ESB	DSB	Multi
max. brake torque	22 - 800 ft/lb	140 - 320 ft/lb	87 - 870 ft/lb
for Safety chuck:	Mini / 19-25 / 22-30 / 30-40 / 40-50 / 50-80 / Sliding Chucks / Series A / Series P		



ESB / DSB

Les freins à simple et double disques sont utilisés pour des applications simples et comme freins de sécurité.

- manuels, pneumatiques, pneumatiques avec membrane

Single disc brakes and Double disc brakes are usable for simple applications with safety chucks.

The brake system is available in different versions

- manual, pneumatical, pneumatical with membrane cylinder

Multi

- facilement adaptable
- changement rapide des plaquettes de frein
- refroidissement du disque et des plaquettes
- bon rapport qualité / prix
- grande plage de couple et performance élevée
- majoritairement composé d'éléments standards, sa maintenance est simplifiée
- technologie de pointe pour le traitement des disques afin de limiter les bruits et vibrations

- easily adaptable to different torque ranges and power requirements
- quick and easy change out of the brake linings
- ventilated brake rotor
- adaptable to many different mounting arrangements
- better value for your purchase price
- wide range of torque and performance requirements
- our huge inventory of these standard parts makes maintenance easy and less expensive
- brake pad dampeners reduce noise and vibration
- more than a safety chuck brake - a brake for use in all applications

Tous les freins sont adaptés à tous les paliers Boschert.

All our brakes are adjusted to fit to Boschert Chucks.
For more information please have a look at the catalog or contact us.

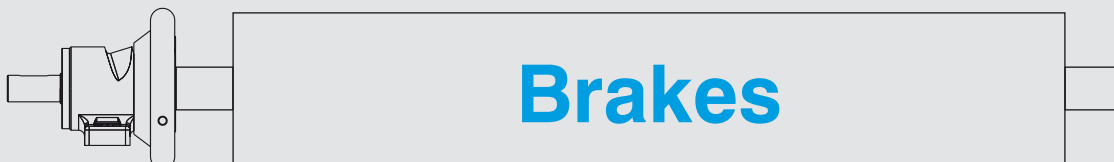

Brakes



Easy Wind Easy Wind Twin Easy Wind Sensitive

Le „Plug and Play“
Régulateur de tension

- installation simple
- tension de bande constante proportionnelle au diamètre
- lecture ultrason du diamètre de bobine
- réglages simplifiés

Easy Wind:

Version standard pour 1 déroulage
Standard solution for one roll

Easy Wind Twin:

Pour 2 déroulages (2 capteurs US - 1 seule commande)
The solution for two rolls (two sensors, one control unit)

Easy Wind Sensitive:

Les pistons du frein peuvent être alimentés séparément
Each brake caliper can be shut on or off

The „Plug and Play“
Tension Control

- easy installation
- constant tension over whole diameter
- ultrasonic sensor measuring the roll diameter
- simple to use



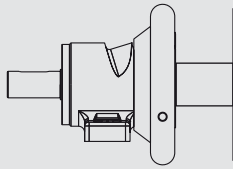

L'équipe des paliers de sécurité

Safety chuck team

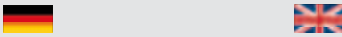
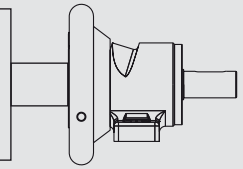

Helmut Turowski

Responsable ventes - achats
Sales manager

Phone: + 49 (0) 7621 - 9593 - 36
E-mail: h.turowski@boschert.de

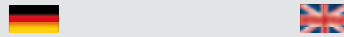

Silvia Schwarzwälder

Commerciale paliers
Sales Safety Chucks

Phone: + 49 (0) 7621 - 9593 - 26
E-mail: s.schwarzwaelder@boschert.de

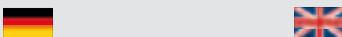

Sabrina Wehrle

Commerciale paliers
Sales Safety Chucks

Phone: + 49 (0) 7621 - 9593 - 74
E-mail: s.wehrle@boschert.de

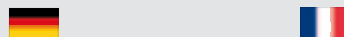

Antoine Pelayo

Etude Paliers
Designer

Phone: + 49 (0) 7621 - 9593 - 37
E-mail: a.pelayo@boschert.de



BOSCHERT GmbH + Co. KG
Division équipement d'enroulage
Division wind technology

Mattenstrasse 1
79541 Lörrach - Hauingen
Germany

Phone: + 49 (0) 7621 - 9593 0
Fax: + 49 (0) 7621 - 5518 4
E-mail: infokl@boschert.de
Internet: www.boschert.de

